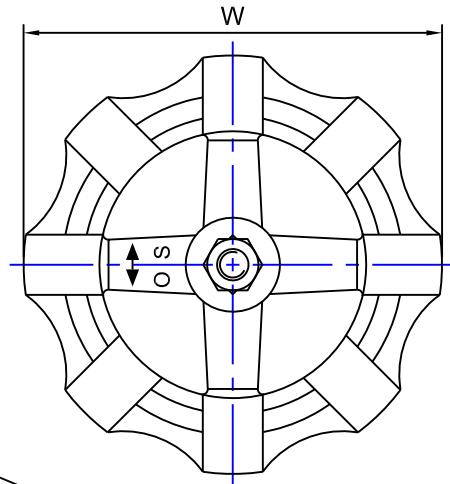

Fig No:

WARREN-222



BODY MARK

1/2

CF8M
200

WARREN
→

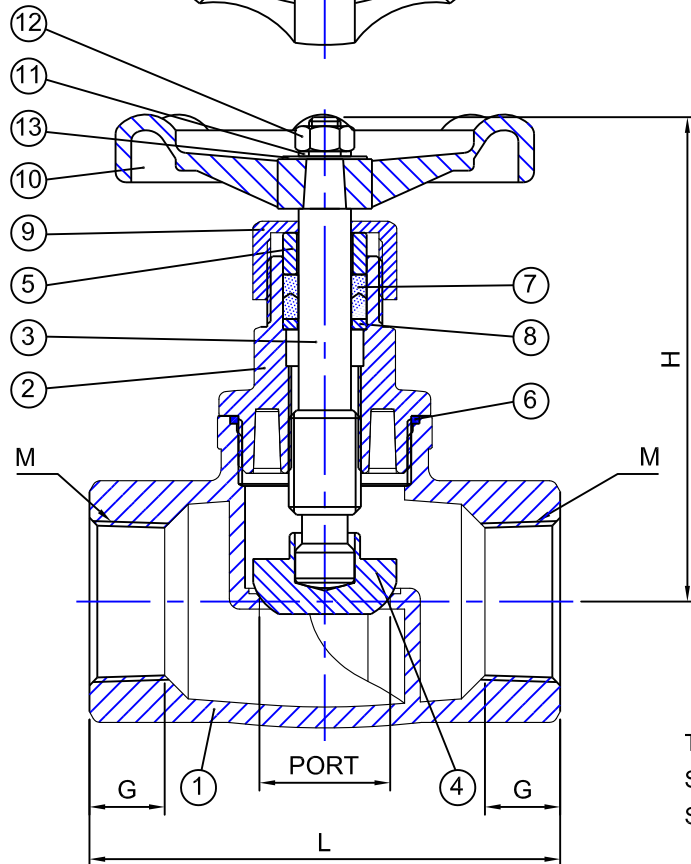

TEST PRESSURE:
Shell (by Water), 300 Psig
Seat (by Air), 80 Psig

APPLICABLE STANDARDS:
NPT Threads To ANSI B 1.20.1

MATERIAL LIST

NO.	PART NAME	MATERIAL	Q'TY
		STAINLESS STEEL	
1	BODY	ASTM A351-CF8M	1
2	CAP	ASTM A351-CF8M	1
3	STEM	AISI SS316	1
4	DISC	AISI SS316	1
5	GLAND	AISI SS316	1
6	GASKET	PTFE	1
7	PACKING	PTFE	1SET
8	WASHER (2)	AISI SS316	1
9	GLAND NUT	ASTM A351-CF8M	1
10	HANDLE WHEEL	ADC 12	1
11	WASHER (1)	AISI SS304	1
12	HANDLE WHEEL NUT	AISI SS304	1
13	NAME PLATE	ALUMINUM	1

DIMENSIONS

unit:inch

SIZE	PORT	L	G	H		W	M	CV(GPM)	TORQUE(LBF-IN)	WEIGHT(LBS)	
				OPEN	CLOSE						
DN15	1/2"	0.59	2.59	0.47	3.88	3.59	2.76	NPT	3.2	150.47	0.97
DN20	3/4"	0.79	2.93	0.55	4.03	3.58	2.76	NPT	5.9	150.47	1.45
DN25	1"	0.98	3.54	0.57	4.35	3.74	3.15	NPT	8.9	177.02	1.90
DN32	1-1/4"	1.26	4.20	0.70	5.07	4.36	3.15	NPT	15	221.28	2.69
DN40	1-1/2"	1.57	4.70	0.72	5.76	4.97	3.94	NPT	27	318.64	4.01
DN50	2"	1.97	5.47	0.88	6.34	5.48	3.94	NPT	41	398.3	5.56



		APPROVED BY.	CHECK BY.	DRAWN BY.	DRAWINGNO.	MATERIAL	UNIT	DESCRIPTION			
SIGN	DATE	CHANG	PETER CHEN	Ann	WARREN-222	ASTM A351-CF8M	INCH	STAINLESS STEEL GLOBE VALVES, THREADED END, 200 WOG			
		05/02/2012	05/02/2012	05/02/2012	REVISION	SCALE	FREE				