

DISC FOR 3"

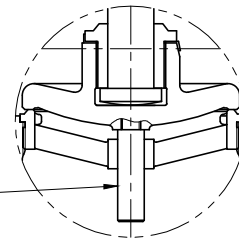

DISC FOR 10" AND OVER

TEST PRESSURE			
HYDRAULIC TEST		kgf/cm <sup>2</sup>	psi
	SHELL	24.6	350
	SEAT	15.8	225

**NOTES**

- \* Applicable Standard
- 1. Face to Face : ASME B16.10
- 2. Flange Dimension : ASME B16.24, FF
- 3. Inspection & Test : API 598
- 4. Country of Origin : Korea

N1	NAME PLATE	AL / BRASS / 304 S.S	
64	SPLIT PIN	BRASS	
52	HAND WHEEL	A126 - CL.B	
43	GASKET	NON - ASBESTOS	
42	PACKING	PTFE	
33	GLAND NUT	B124 - C37700	
31	BONNET NUT	B124 - C37700	
23	GLAND BOLT	B124 - C37700	
21	BONNET BOLT	B124 - C37700	
19	DISC GUIDE	B150 - C63000	10" AND OVER
18	DISC LOCK WASHER	BRASS	
16	HAND WHEEL NUT	B124 - C37700	
12	GLAND FLANGE	B62 - C83600	
11	STEM	B150 - C63000	
7	SEAT RING	B62 - C83600	
4	DISC NUT	B62 - C83600 / B150 - C63000	
3	DISC	B62 - C83600	
2	BONNET	B62 - C83600	
1	BODY	B62 - C83600	
NO.	PART NAME	MATERIAL	REMARKS



[ Unit : mm ]

NPS	BORE φd	FLANGE ASME 150lbs FF					L1	H	φW
		φD	φC	t	n	φh			
2"	50.8	150	120.7	12.7	4	19	102	280	180
2½"	63.5	180	139.7	14.2	4	19	108	310	200
3"	76.2	190	152.4	15.7	4	19	121	392	224
4"	101.6	230	190.5	17.5	8	19	146	356	280
5"	127	255	215.9	19.1	8	22	178	413	315
6"	152.4	280	241.3	20.6	8	22	203	457	355
8"	203.2	345	298.5	23.9	8	22	248	580	355
10"	254	405	362.0	25.4	12	25	311	650	355
12"	304.8	480	431.8	26.9	12	25	349	740	400

△					
△					
△	2020.11.03	Material changed		J.S.LIM	S.K.CHOI H.Y.JUNG
REV. NO.	DATE	DESCRIPTION	DRW'D BY	CHK'D BY	APP'D BY

TITLE		CAST BRONZE ANGLE VALVE				
RATING	Class 150	SIZE	See table	UNIT	mm	
DRW'D BY	CHK'D BY	APP'D BY	DATE	2018.07.10	SCALE N / S	
J.S.LIM	H.Y.JUNG	S.H.AHN	TYPE	Bolted Bonnet		
			DWG. NO.	ANV - BC - 150P - 2 ~ 12B		
SPACE FIG NO.		15045 - B				