

SIZE	A	B	C	D	E	F	G	H	H ₁ -H ₂ -H ₃ -H ₄	J	K	L2	M2
2	6 3/8	3 3/16	1 7/8	1 1/4	1/2	2.25	N/A	0.39	1/8-5/8-1/2-9/16	10.5	4 3/4	11/16	4
2 1/2	6 7/8	3 1/2	2	1 1/4	1/2	2.25	N/A	0.39	1/8-5/8-1/2-9/16	10.5	5 1/2	11/16	4
3	7 1/8	3 3/4	2	1 1/4	1/2	2.25	N/A	0.39	1/8-5/8-1/2-9/16	10.5	6	11/16	4
4	7 7/8	4 1/2	2 1/8	1 1/4	5/8	2.25	N/A	0.47	3/16-7/8-3/4-3/4	10.5	7 1/2	11/16	4
5	8 3/8	5	2 3/8	1 1/4	3/4	2.25	N/A	0.55	3/16-1-3/4-13/16	10.5	8 1/2	13/16	4
6	8 7/8	5 1/2	2 3/8	1 1/4	3/4	2.25	N/A	0.55	3/16-1-3/4-13/16	10.5	9 1/2	13/16	4
8	10 1/4	6 7/8	2 1/2	1 3/4	7/8	3.34	N/A	0.67	3/16-1-3/4-1	14.0	11 3/4	13/16	4
10	11 1/2	8	2 3/4	1 3/4	1 1/8	3.34	N/A	0.87	1/4-1 3/8-1-1 1/4	14.0	14 1/4	15/16	4
12	13 1/4	9 5/8	3 1/8	1 3/4	1 1/4	3.34	N/A	0.95	1/4-1 3/8-1-1 3/8	14.0	17	15/16	4

BILL OF MATERIAL

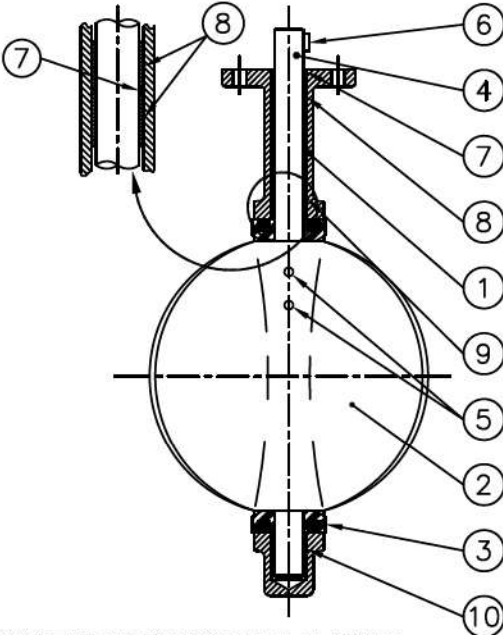

ITEM	DESCRIPTION	MATERIALS	ASTM
1	BODY	DUCTILE IRON	ASTM A395
2	DISC	ALUMINUM BRONZE	ASTM B148
3	SEAT	BUNA-N	
4	SHAFT	316 STAINLESS STEEL	ASTM A276
5	TAPER PIN	316 STAINLESS STEEL	ASTM A276
6	KEY	CARBON STEEL	
7	O RING	BUNA-N	
8	BUSHING	PTFE	
9	BUSHING	PTFE	
10	BUSHING	PTFE	
11	HANDLE		

* RECOMMENDED SPARE PARTS

NOTES:

- "C" DIM. IS ELASTOMER SHOWN IN RELAXED CONDITION. APPROX. 1/8" TOTAL COMPRESSION REQUIRED FOR SEAL.
- LINE FLANGE DIMENSIONS COMPLY WITH ANSI B16.1 CLASS 125 (Iron) and B16.5 Class 150 (Steel)
- MSS-SP-67 TYPE I

Fig. Number | | A G 0 6 4 3 1 2

**WEIGHT INCLUDES HANDLE, GEAR OP OR ACTUATOR (BRACKETS AND OTHER ACCESSORIES WEIGHT NOT INCLUDED)

SIZE	**WEIGHT (lbs) WAFER
2	7.8
2 1/2	8.8
3	11.8
4	14.8
5	19.8
6	21.8
8	36
10	46
12	74

CUSTOMER: W&O SUPPLY	PROPRIETARY NOTE: THIS MATERIAL IS THE PROPERTY OF CRANE ENERGY FLOW SOLUTIONS AND IS FURNISHED FOR THE PURPOSE INDICATED. ANY AND ALL COMMERCIAL, PROPRIETARY, TRADE, AND OTHER RIGHTS IN THIS SUBJECT MATTER IS RESERVED INCLUDING ANY INVENTIVE RIGHTS OF THE MANUFACTURER OR USER OF THE SUBJECT MATTER. THIS MATERIAL DOES NOT CONVEY ANY TITLE TO THE SUBJECT MATTER.
CUSTOMER PO:	
CRANE ORDER NO.:	
DATE:	
CERTIFIED BY:	

<p>CRANE</p> <p>Crane Energy Flow Solutions Conroe Operations Montgomery, Texas, USA</p>			
<p>DRAWING NAME: 2"-12" SERIES 200 WAFER BUTTERFLY VALVE WITH HANDLE 200 PSI</p>			
B 08/18/13	JC	EC08 23282	DWG NO.:
A 03/02/08	ACL	ORIGINAL RELEASE	2-12AG064312
			REV. B
			SCALE: NTS SHEET: 1 OF 1

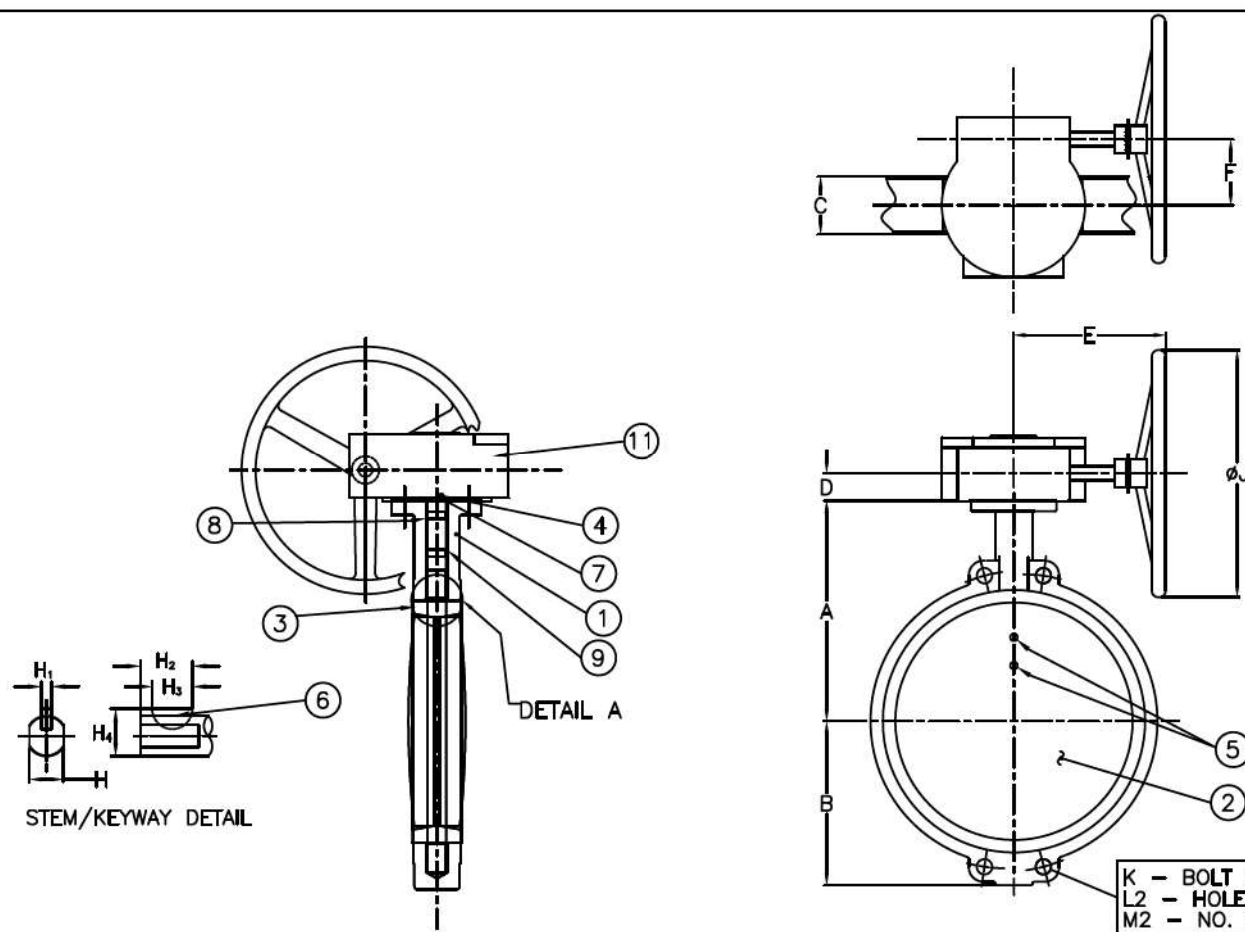

SIZE	A	B	C	D	E	F	G	H	H ₁ -H ₂ -H ₃ -H ₄	∅J	K	L2	M2
14	14 1/2	10 1/2	3 1/8	1.53	9.04	3.12	N/A	0.95	1/4-1 3/8-1-1 3/8	12.00	18 3/4	1 1/16	4
16	15 3/4	12 7/8	3 1/2	2.28	11.08	4.80	N/A	1.06	5/16-1 3/4-1 3/4-1 1/2	18.00	21 1/4	1 1/16	4
18	16 5/8	13 5/8	4 1/4	2.28	11.08	4.80	N/A	1.06	3/8-1 1/2-1 1/2-1 1/16	18.00	22 3/4	1 1/4	4

BILL OF MATERIAL

ITEM	DESCRIPTION	MATERIALS	ASTM
1	BODY	DUCTILE IRON	ASTM A395
2	DISC	ALUMINUM BRONZE	ASTM B148
* 3	SEAT	BUNA-N	
4	SHAFT	316 STAINLESS STEEL	ASTM A276
* 5	TAPER PIN	316 STAINLESS STEEL	ASTM A276
6	KEY	CARBON STEEL	
* 7	O RING	BUNA-N	
8	BUSHING	PTFE	
9	BUSHING	PTFE	
10	BUSHING	PTFE	
11	ACTUATOR	GEAR OPERATOR	

* RECOMMENDED SPARE PARTS

NOTES:

- "C" DIM. IS ELASTOMER SHOWN IN RELAXED CONDITION. APPROX. 1/8" TOTAL COMPRESSION REQUIRED FOR SEAL.
- LINE FLANGE DIMENSIONS COMPLY WITH ANSI B16.1 CLASS 125 (Iron) and B16.5 Class 150 (Steel)
- MSS-SP-67 TYPE I

Fig. Number

**WEIGHT INCLUDES HANDLE, GEAR OP OR ACTUATOR (BRACKETS AND OTHER ACCESSORIES WEIGHT NOT INCLUDED)

SIZE	**WEIGHT(lbs)
14"	126.7
16"	194.4
18"	242.4

CUSTOMER: _____
 CUSTOMER PO: _____
 CRANE ORDER NO: _____
 DATE: _____
 CERTIFIED BY: _____

PROPRIETARY NOTE
 THIS DRAWING IS THE PROPERTY OF CRANE ENERGY SOLUTIONS AND IS INTENDED FOR THE PURPOSES INDICATED. ANY AND ALL COPYRIGHT, PROPRIETARY, TRADE, AND OTHER RIGHTS IN THIS SUBJECT MATTER IS RESERVED INCLUDING ANY PATENTS, TRADEMARKS, OR SERVICE MARKS. NO PART OF THIS DRAWING OR THE INFORMATION HEREON IS TO BE REPRODUCED, COPIED, OR TRANSMITTED IN ANY FORM OR BY ANY MEANS, ELECTRONIC OR MECHANICAL, INCLUDING PHOTOCOPYING, RECORDING, OR BY ANY INFORMATION STORAGE AND RETRIEVAL SYSTEM, WITHOUT THE WRITTEN PERMISSION OF CRANE ENERGY SOLUTIONS. THIS DRAWING IS TO BE USED ONLY AS AN OFFICIAL OR SPECIFIC AUTHORITY OF CRANE ENERGY SOLUTIONS AS DESIGN OR SUBSEQUENT.

CRANE Crane Energy Flow Solutions
 Conroe Operations
 Montgomery, Texas, USA

DRAWING NAME: 14"-18" SERIES 200 WAFER BUTTERFLY VALVE 150 PSI

DWG NO.: 14-18AG664315 REV. B

B 05/24/13 JC REDRAWN
 A 10/01/07 ACL ORIGINAL RELEASE SCALE: NTS SHEET: 1 OF 1