

TECHNICAL DATA

STAINLESS STEEL WAFER SPRING CHECK VALVE PN40

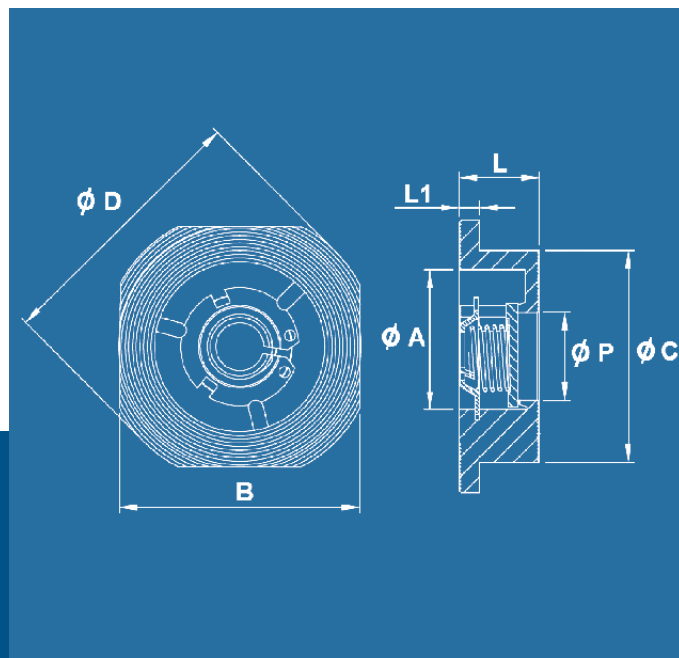

MATERIAL LIST

1 Body	ASTM 351 CF8M
2 Disc	ASTM A240-316
3 Spring	SS 316
4 Spring holder	ASTM A240-316

DN 15 – 80

DN100

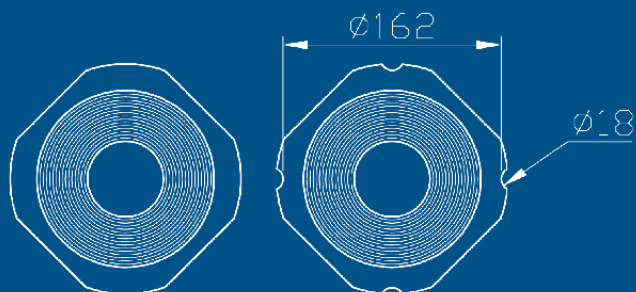

FEATURES

Size	DN 15 to DN 100
Ends	Between flanges PN10/16/25/40 and Class 150
Min. Temperature	- 20°C
Max. Temperature	+ 200°C
Max. Pressure	40 Bars
Specifications	Spring type All positions Metal / metal

DIMENSIONS

DN (mm)	ØA (mm)	B (mm)	ØC (mm)	ØD (mm)	L (mm)	L1 (mm)	ØP (mm)	Weight (kg)
15	34	44.6	40.5	54	16	3.5	12.5	0.1
20	39	54	47	62	19	3.5	20	0.2
25	46	65	56	73	22	4	25	0.3
32	60	78	70	83	28	5	32	0.5
40	70	88	80	93	31.5	5	38	0.6
50	79	101.6	90	107	40	5	49	0.9
65	101	120.4	113	126.5	46	5.5	64	1.4
80	109	133	123	141.2	49	5.5	78	2
100	134	164	150	171.4	64	6.5	98	3