

Milwaukee Figure 1291

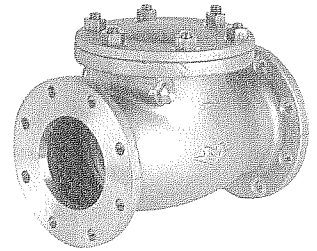

Bronze Flanged End Monel Trim Swing Check Valve Flanged to ASME/ANSI B16.24

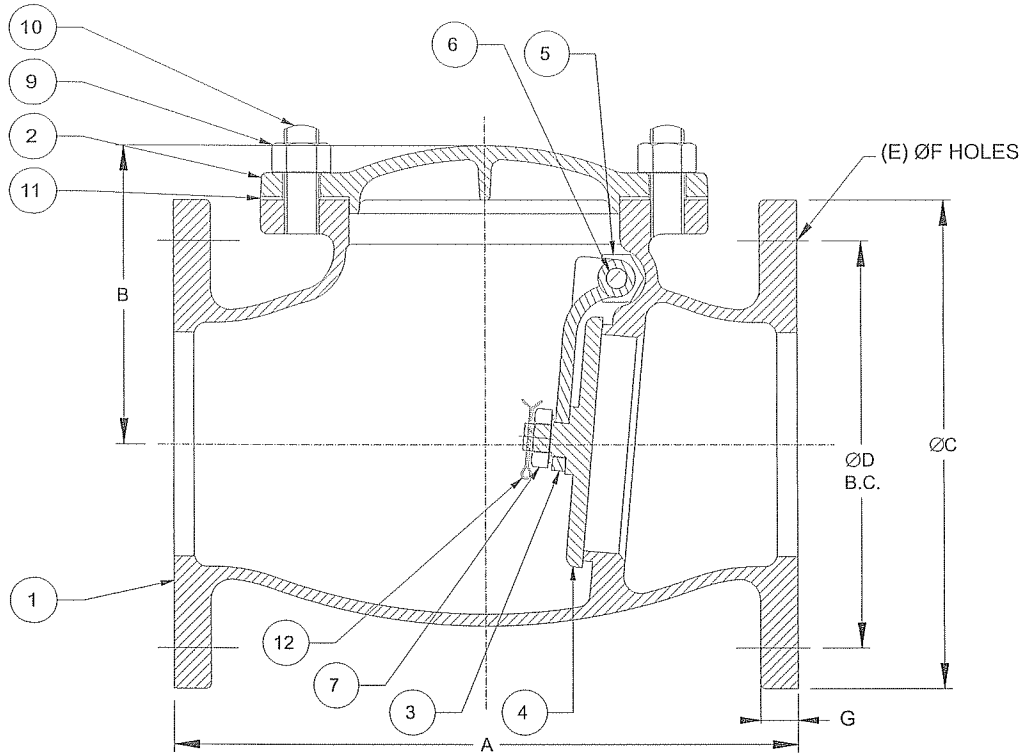

BILL OF MATERIAL

Item	Description	Material	Specification
1	Body	Bronze	ASTM B61
2	Cap	Bronze	ASTM B61
3	Lever	Bronze	ASTM B61
4	Disc	Bronze	ASTM B61
5	Plug, Hinge Pin	Ni-Cu Alloy	ASTM B164 CL B
6	Hinge Pin	Ni-Cu Alloy	ASTM B164 CL B
7	Disc Nut	Ni-Cu Alloy	ASTM B164 CL B
8	Washer	Ni-Cu Alloy	ASTM B164 CL B
9	Nut	Naval Brz.	ASTM B21
10	Stud	Naval Brz.	ASTM B21
11	Gasket	Syn. Rubber	MIL-R-1149
12	Cotter Pin	Ni-Cu Alloy	ASTM B164 CL A

DIMENSIONS

Size	2	2.5	3	4	5	6	8	10	12
A	7.88	9.13	10.00	11.50	13.00	14.00	19.50	24.50	27.50
B	3.88	4.25	4.69	5.50	6.38	8.00	10.38	14.00	17.00
ØC	6.00	7.00	7.50	9.00	10.00	11.00	13.50	16.00	19.00
ØD	4.75	5.50	6.00	7.50	8.50	9.50	11.75	14.25	17.00
E	4	4	4	8	8	8	8	12	12
ØF	.75	.75	.75	.75	.88	.88	.88	1.00	1.00
G	.50	.56	.63	.69	.75	.81	.93	1.00	1.06

SERVICE RATINGS

225 WOG/150 SWP

Allowable leakage 40/ml/hr/inch pipe size at Full Rated Pressure

Notes: ASME B16.10 does not cover end-to-end dimensions of bronze valves. E-E dimensions were therefore historically developed from use-based standards. In this valve series, valves smaller than 4" nominal size DO NOT meet ASME B16.10 for end-to-end dimensions.