

TEST PRESSURE

HYDRAULIC TEST		kgf/cm ²	psi
	SHELL	24.6	350
	SEAT	15.8	225

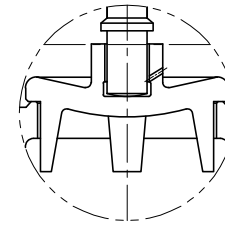

DISC FOR 4"

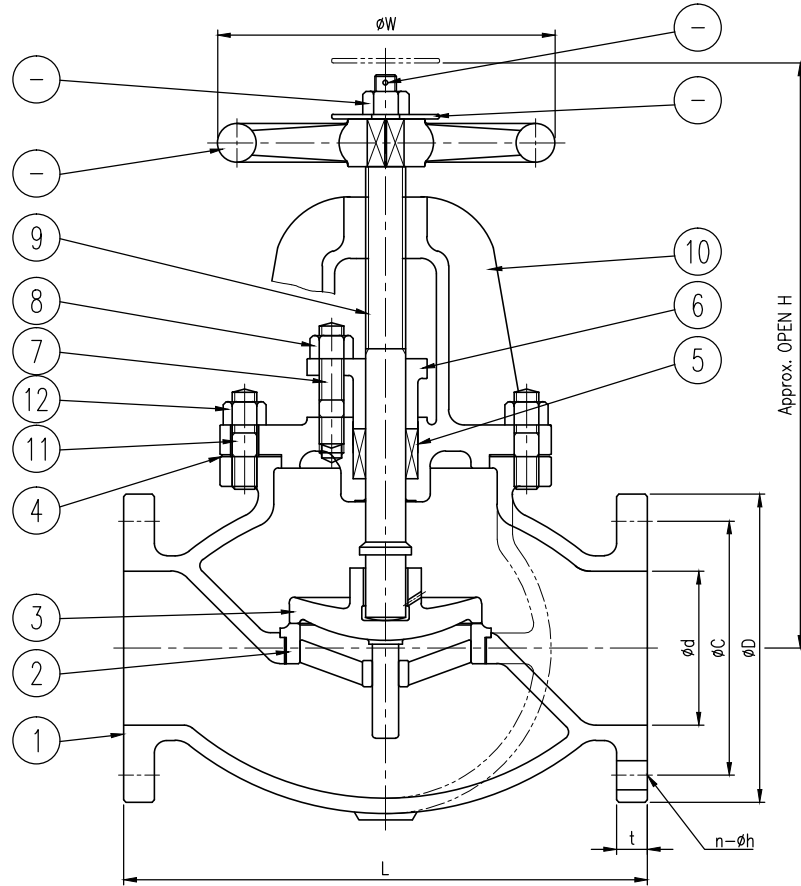
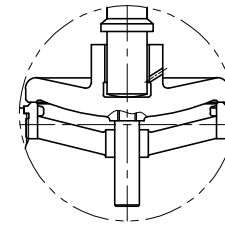

DISC FOR 10" AND OVER

[Unit : mm]

NPS	BORE ød	FLANGE ASME 150lbs FF					L	H	øW
		øD	øC	t	n	øh			
2"	50.8	150	120.7	12.7	4	19	203	280	180
2-1/2"	63.5	180	139.7	14.2	4	19	216	310	200
3"	76.2	190	152.4	15.7	4	19	241	356	224
4"	101.6	230	190.5	17.5	8	19	292	395	280
5"	127	255	215.9	19.1	8	22	356	413	315
6"	152.4	280	241.3	20.6	8	22	406	457	355
8"	203.2	345	298.5	23.9	8	22	495	580	355
10"	254	405	362.0	25.4	12	25	622	650	355
12"	304.8	480	431.8	26.9	12	25	698	740	400

NOTES

- * Applicable Standard
- 1. Face to Face : ASME B16.10
- 2. Flange Dimension : ASME B16.24, FF
- 3. Inspection & Test : API 598
- △ 4. Country of Origin : Korea

NO.	PART NAME	MATERIAL	REMARKS
17	DISC GUIDE	B124-37700	
16	SPLIT PIN	BRASS	
15	NAME PLATE	AL/BRASS/304 S.S	
14	HAND WHEEL NUT	B124-C37700	
13	HAND WHEEL	A126-CL.B	
12	BONNET NUT	B124-C37700	
11	BONNET BOLT	B124-C37700	
10	BONNET	B62-C83600	
9	STEM	B150-C63000	
8	GLAND NUT	B124-C37700	
7	GLAND BOLT	B124-C37700	
6	GLAND FLANGE	B62-C83600	
5	PACKING	PTFE	
4	GASKET	NON-ASBESTOS	
3	DISC	B62-C83600	
2	SEAT RING	B62-C83600	
1	BODY	B62-C83600	

REV. NO.	DATE	DESCRIPTION	DRW'D BY	CHK'D BY	APP'D BY
△	-	-			
△	2019.07.25	Material changed	J.S.LIM	H.Y.JUNG	S.H.AHN

TITLE		CAST BRONZE GLOBE CHECK VALVE				
RATING	Class 150	SIZE	See table	UNIT	mm	
DRW'D BY	CHK'D BY	APP'D BY	DATE	2018.07.09	SCALE	N/S
J.S.LIM	H.Y.JUNG	S.H.AHN	TYPE	Bolted Bonnet		
			DWG. NO.	GCV-BC-150P-2~12B		



SPACE FIG NO.	15035-B-SC
---------------	------------